

SPIKA MS410 REMOTE

THREE PHASE
400 V / 50 Hz

MACHINE À GLAÇONS MODULAIRE

FEATURES CARACTÉRISTIQUES

- ▶ **PRODUCES FULL DICE ICE CUBES OR HALF DICE ICE CUBES.**
PRODUCTION DE DÉS OU DE DEMI-DÉ.
- ▶ **HIGH EFFICIENT EVAPORATOR.**
ÉVAPORATEUR À HAUT RENDEMENT.
- ▶ **SMART WATER DISTRIBUTOR THAT IMPROVES DROP-OFF EFFICIENCY.**
LE DISTRIBUTEUR D'EAU INTELLIGENT AMÉLIORE L'EFFICACITÉ DU DÉCOLLAGE.
- ▶ **EASY ACCESS BY REMOVING THE PANELS WITH A SINGLE SCREWDRIVER.**
ACCÈS FACILE EN RETIRANT LES PANNEAUX AVEC UN SEUL TOURNEVIS.
- ▶ **SMART ELECTRONIC BOARD CONTROLS EVERY PARAMETER IN THE MACHINE AND SHOWS THE DIAGNOSIS OF POSSIBLE INCIDENCES.**
PLAQUE ÉLECTRONIQUE INTELLIGENTE QUI SURVEILLE LES PARAMÈTRES DE LA MACHINE ET AFFICHE LES DIAGNOSTICS DES ÉVENTUELS DYSFONCTIONNEMENTS.
- ▶ **ENERGY STAR, LOW POWER CONSUMPTION CERTIFICATION.**
ENERGY STAR, CERTIFIÉ FAIBLE CONSOMMATION D'ÉNERGIE.
- ▶ **HIGH RESISTANCE EXTERNAL FRAME IN AISI 304 STAINLESS STEEL.**
STRUCTURE À HAUTE RÉSISTANCE EN ACIER INOXYDABLE AISI 304.

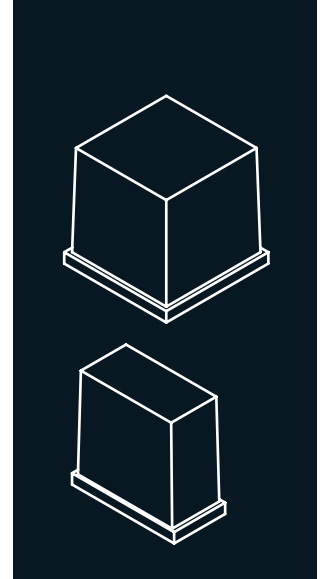

	24 H (Kg)	10°C 10°C (Kg)	21°C 15°C (Kg)	(mm)	(mm)	
SPIKA MS410R	424	405	405	Width 760 Depth 620 Height 762	Width 836 Depth 635 Height 874	SPIKA HALF DICE 6gr 23 mm (W) x 11 mm (D) x 26 mm (H) Average dimensions Dimensions moyennes
RC10S	-	-	-	Width 425 Depth 746 Height 566	Width 510 Depth 770 Height 700	SPIKA FULL DICE 12gr 26 mm (W) x 23 mm (D) x 26 mm (H) Average dimensions Dimensions moyennes

ACCESSORIES ACCESSOIRES

INCLUDED



WATER INLET FILTER GASKET
JOINT DE FILTRE D'ENTRÉE D'EAU



WATER INLET HOSE
TUYAU D'ENTRÉE D'EAU



WATER OUTLET HOSE
TUYAU D'ÉVACUATION

NOT INCLUDED (OPTIONAL)



ANTI-LIMESCALE FILTER
FILTRE ANTICALCAIRE



PARTICLE FILTER
FILTRE ANTIPARTICULES



ANTI-LIMESCALE + ANTI-CHLORINE FILTER CS101
FILTRE ANTICALCAIRE + ANTI-CHLORE CS101

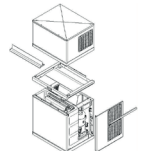

STACKING KIT
KIT EMPILAGE

RECOMMENDED BINS RÉSERVOIRS CONSEILLÉS



SPIKA MS410 REMOTE

RIGHT SIDE VIEW
VUE LATÉRALE DROITE

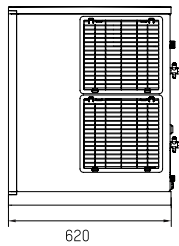

FRONTAL VIEW
VUE DE FACE

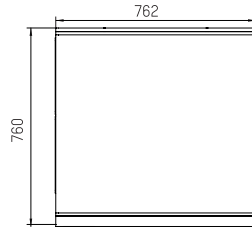

REAR VIEW
VUE ARRIÈRE

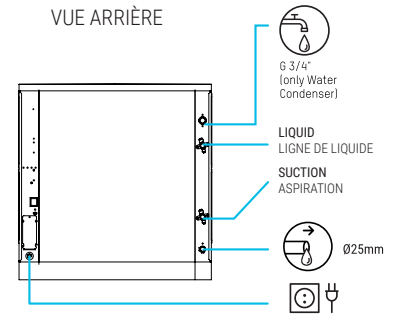

CENTRAL CROSS SECTION
VIEW OF THE BASE
VUE DE LA BASE DEPUIS LA SECTION CENTRALE

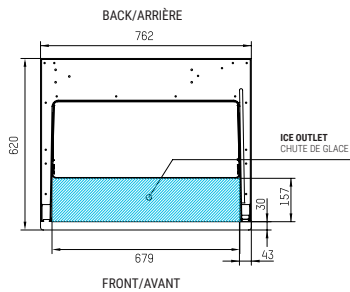

RC10S

RIGHT SIDE VIEW
VUE LATÉRALE DROITE

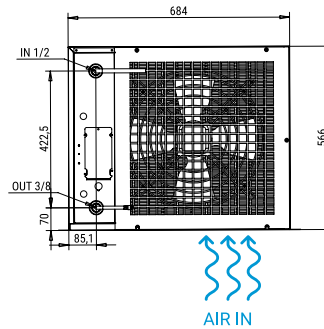

TOP VIEW
VUE EN PLAN

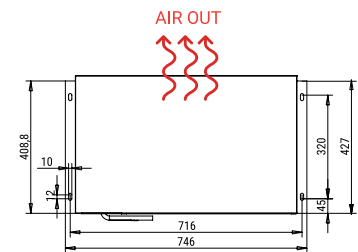

*All measurements in mm.
*Toutes les cotes sont en mm.

OPERATING CONDITIONS CONDITIONS DE FONCTIONNEMENT

PRODUCTION 50Hz PRODUCTION 50 Hz

±10% V

10°C/43°C

5°C/38°C

1 bar/6 bar

400/800 Ice cubes/cycle

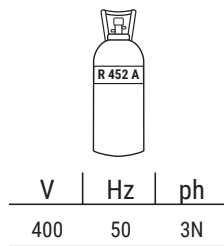

		SPIKA MS410 R			
		10°	15°	21°	30°
		50°	60°	70°	86°
10°	424	412	403	379	
50°	413	405	394	379	
21°	395	366	335	318	
68°	331	290	265	249	
32°					
90°					
43°					
109°					

MODÈLES

SPIKA MS410R

RC10S

	+C° -C°	ASHRAE CONDITIONS CONDICIONES ASHRAE (W) (BTU/h)	(W) 43°C	(n.) (mm ²)	FUSE	100 Kg (Kwh)	(l/h) FULL HALF	HEAT REJECTED (W) (BTU/h)	(Kg)	(Kg)	(m ³)
SPIKA MS410R		11.185 38.185	1.540	3 2,5	15	9,9	17 17	3.505 11.960	105	110	0,53
RC10S		- -	200	2 1,5	10	-	- -	- -	40	50	0,27



ITV ICE MAKERS, S.L.
POL. IND. SECTOR 13, AVDA. DELS HOSTALERS, 2
46394 RIBARROJA DE TURIA, VALENCIA, SPAIN
PHONE: +34 96 166 75 75 | FAX: +34 96 166 81 00
info@itv.es | www.itv.es



SERVICE
SERVICE D'ASSISTANCE TECHNIQUE
service@itv.es
Skype: ITV.Service
+34 961 667 639
8:00AM | 7:00PM



Subject to certain limitations
and exclusions. Only spare parts.
Sujet à limitations et exclusions.
Pièces de rechange uniquement.

