

SPIKA MS410 THREE PHASE 400 V / 50 Hz

MODULAR ICE CUBE MACHINE

FEATURES CARACTERÍSTICAS

- ▶ **PRODUCE FULL DICE ICE CUBES OR HALF DICE ICE CUBES**
PRODUCE CUBITOS DE DADO Y MEDIO DADO
- ▶ **NEW 'SENTINEL' DISPLAY SYSTEM PROTECTS THE MACHINE AND OPTIMISES PERFORMANCE**
NUEVO SISTEMA DE DISPLAY "SENTINEL" QUE PROTEGE LA MÁQUINA Y OPTIMIZA EL RENDIMIENTO
- ▶ **HIGH EFFICIENT EVAPORATOR**
EVAPORADOR DE ALTA EFICIENCIA
- ▶ **SMART WATER DISTRIBUTOR THAT IMPROVES DROP-OFF EFFICIENCY**
DISTRIBUIDOR DE AGUA INTELIGENTE QUE MEJORA LA EFICIENCIA EN EL DESPEGUE
- ▶ **EASY ACCESS BY REMOVING THE PANELS WITH A SINGLE SCREWDRIVER**
FÁCIL ACCESO RETIRANDO LOS PANELES CON UN SOLO DESTORNILLADOR
- ▶ **SMART ELECTRONIC BOARD CONTROLS EVERY PARAMETER IN THE MACHINE AND SHOWS THE DIAGNOSIS OF POSSIBLE INCIDENCES**
PLACA ELECTRÓNICA INTELIGENTE QUE CONTROLA LOS PARÁMETROS DE LA MÁQUINA Y MUESTRA EL DIAGNÓSTICO DE POSIBLES INCIDENCIAS
- ▶ **ENERGY STAR, LOW POWER CONSUMPTION CERTIFICATION**
ENERGY STAR, CERTIFICADO DE BAJO CONSUMO ELÉCTRICO
- ▶ **HIGH RESISTANCE EXTERNAL FRAME IN AISI 304 STAINLESS STEEL**
ESTRUCTURA DE ALTA RESISTENCIA EN ACERO INOXIDABLE AISI 304

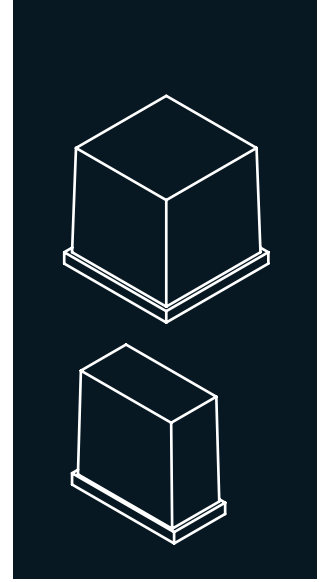

	24 H	10°C	21°C			
SPIKA MS410 A		424	405	Width 760 Depth 620 Height 762	Width 836 Depth 635 Height 874	SPIKA HALF DICE 6gr 23 mm (W) x 11 mm (D) x 26 mm (H) Average dimensions Dimensiones promedio
SPIKA MS410 W		436	416			SPIKA FULL DICE 12gr 26 mm (W) x 23 mm (D) x 26 mm (H) Average dimensions Dimensiones promedio

ACCESSORIES ACCESORIOS

INCLUDED



WATER INLET FILTER GASKET
JUNTA DE FILTRO DE ENTRADA DE AGUA



WATER INLET HOSE
MANGUERA DE ENTRADA DE AGUA



WATER OUTLET HOSE
MANGUERA DE DESAGÜE

NOT INCLUDED (OPTIONAL)



ANTI-LIMESCALE FILTER
FILTRO ANTICAL



PARTICLE FILTER
FILTRO ANTIPARTÍCULAS



ANTI-LIMESCALE + ANTI-CHLORINE FILTER CS101
FILTRO ANTICAL + ANTICLORO CS101

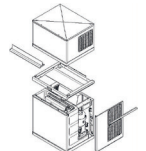

STACKING KIT
KIT APILADO

RECOMMENDED BINS SILOS RECOMENDADOS

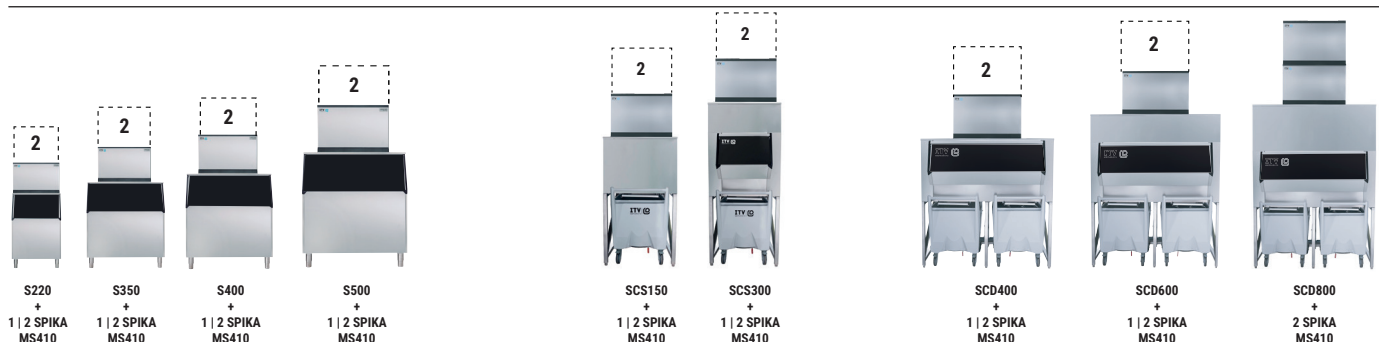

TECHNICAL SCHEME ESQUEMA TÉCNICO

SPIKA MS410

RIGHT SIDE VIEW
VISTA LATERAL DERECHA

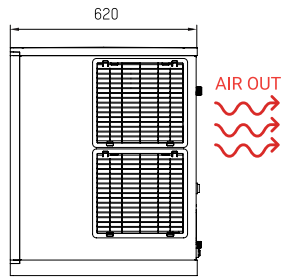

FRONTAL VIEW
VISTA FRONTAL

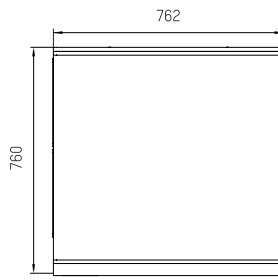

REAR VIEW
VISTA TRASERA

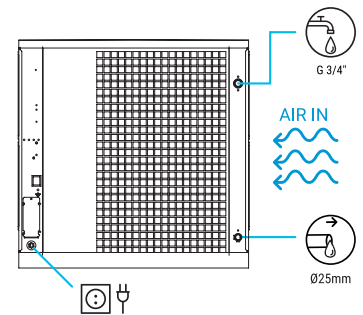

CENTRAL CROSS SECTION
VIEW OF THE BASE
VISTA DE LA BASE DESDE SECCIÓN CENTRAL

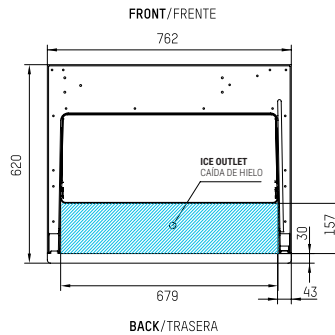

* All measurements in mm.
* Todas las cotas en mm.

OPERATING CONDITIONS CONDICIONES DE OPERACIÓN

PRODUCTION 50Hz PRODUCCIÓN 50 Hz

±10% V

10°C/43°C

5°C/38°C

1 bar/6 bar

400/800 Ice cubes/cycle

R 452 A		
V	Hz	ph
400	50	3N

SPIKA MS410 AIR COOLED

°C °F	10° 50°	15° 60°	21° 70°	30° 86°
	10° 50°	424	412	395
21° 68°	413	405	386	368
32° 90°	359	333	301	284
43° 109°	293	259	232	217

SPIKA MS410 WATER COOLED

°C °F	10° 50°	15° 60°	21° 70°	30° 86°
	10° 50°	436	423	406
21° 68°	425	416	397	378
32° 90°	369	342	310	291
43° 109°	301	266	239	223

MODELS MODELOS

SPIKA MS410 A

SPIKA MS410 W

	ASHRAE CONDITIONS CONDICIONES ASHRAE	(W)	(BTU/h)	(W) 43°C	(n.)	(mm ²)	FUSE	100 Kg (Kwh)	FULL HALF (l/h)	HEAT REJECTED (W)	(BTU/h)	(Kg)	(Kg)	(m ³)
SPIKA MS410 A		11.185	38.185	1.540	3	2,5	15	9,9	17 17	3.505	11.960	105	110	0,53
SPIKA MS410 W		11.185	38.185	1.540	3	2,5	10	9,9	110 110	3.505	11.960	105	110	0,53



ITV ICE MAKERS, S.L.
POL. IND. SECTOR 13, AVDA. DELS HOSTALERS, 2
46394 RIBARROJA DE TURIA, VALENCIA, SPAIN
PHONE: +34 96 166 75 75 | FAX: +34 96 166 81 00
info@itv.es | www.itv.es



SERVICE
SERVICIO ASISTENCIA TÉCNICA
service@itv.es
Skype: ITV.Service
+34 961 667 639
8:00AM | 7:00PM



Subject to certain limitations
and exclusions. Only spare parts.
Sujeto a limitaciones y exclusiones.
Solo piezas de repuesto.



VERTICAL SYSTEM
SISTEMA VERTICAL