

Technical Manual
Manual Técnico

TECHNICAL SERVICE MANUAL SCL - SC

MODELS:

SCL 400 - SC 400

SCL 600 - SC 600

SCL 1T - SC 1TN

SCL 2T - SC 2TN

SCL 3T - SC 3TN

SCL 5T - SC 5TN

SCL 10T - SC 10TN

SCL 15T - SC 15TN

TABLE OF CONTENTS

1. INTRODUCTION.....	4
Warnings.....	4
Overview.....	5
Wiring Diagram.....	6
2. SPECIFICATIONS.....	8
Production Tables.....	11
3. DELIVERY AND UNPACKING.....	13
4. INSTALLATION.....	13
Recommended Placement of Unit.....	13
Installation Procedure.....	14
5. OPERATION.....	14
Preliminary Checks.....	14
Starting up.....	14
Stop.....	15
6. MAINTENANCE AND CLEANING INSTRUCTIONS.....	15
7. TROUBLESHOOTING.....	16

CAREFULLY READ THE INSTRUCTIONS CONTAINED IN THIS MANUAL SINCE THEY PROVIDE IMPORTANT INFORMATION RELATIVE TO SAFETY DURING INSTALLATION, USE, AND MAINTENANCE.

THIS APPLIANCE SHOULD BE INSTALLED BY APPROVED TECHNICAL SERVICE PERSONNEL.

INTRODUCTION

Thank you for choosing SCL - SC Ice Maker.

You have purchased one of the most reliable ice-making products on the market today. Carefully read the instructions contained in this manual since they provide important information relative to safety during installation, use, and maintenance.

1. Warnings

This appliance should be installed by approved Technical Service Personnel.

This plug should be accessible at all times.

To reduce the risk of electrical shock, ALWAYS disconnect the machine BEFORE cleaning or maintaining the equipment. Do not attempt to install, service, or modify this machine. Improper use by other than specially trained technicians is extremely dangerous and may result in a fire or electric shock.

This machine should not be placed outdoors or exposed to rain.

Connect to drinking water mains.

This appliance is not intended for use by young children or infirm persons without supervision.

Young children should be supervised to ensure that they do not play with the appliance.

IMPORTANT!

DO NOT ATTEMPT TO SERVICE THIS MACHINE AS IT IS DANGEROUS AND COULD CAUSE SEVERE DAMAGE TO THE UNIT.

SERVICE SHOULD ONLY BE CARRIED OUT BY TRAINED, QUALIFIED PERSONNEL.

WE STRONGLY RECOMMEND USING ONLY ORIGINAL REPLACEMENT PARTS AVAILABLE FROM AN AUTHORIZED DISTRIBUTOR.

WASTE AND OTHER MATERIAL SHOULD BE DISPOSED OF ACCORDING TO LOCAL REGULATIONS AND PROCEDURES FOR WASTE DISPOSAL.

CLEANING AND MAINTENANCE ARE NOT COVERED BY THE WARRANTY.

2. Overview

Read this service manual carefully before installation, debugging and operation of this ice machine.

This Service Manual gives an introduction of operation conditions, performance parameters, installation and debugging and operating procedures of SCL - SC ice machines.



The ice machine system is of vertical, internal ice scraping type.

The machine is equipped with an electric box with different protections and status lights, namely:

- (1) Ice level
- (2) Water pressure
- (3) Normal operation of reducer's electromotor (it uses a speed driver)
- (4) Low and high pressure switch (compact models)
- (5) Water pump on/off
- (6) Unit on/off

In addition, an alert indicator lights up to indicate the cause of stoppage, thus facilitates the trouble shooting and maintenance.

3. Wiring Diagram

COMPACT SCL - SC

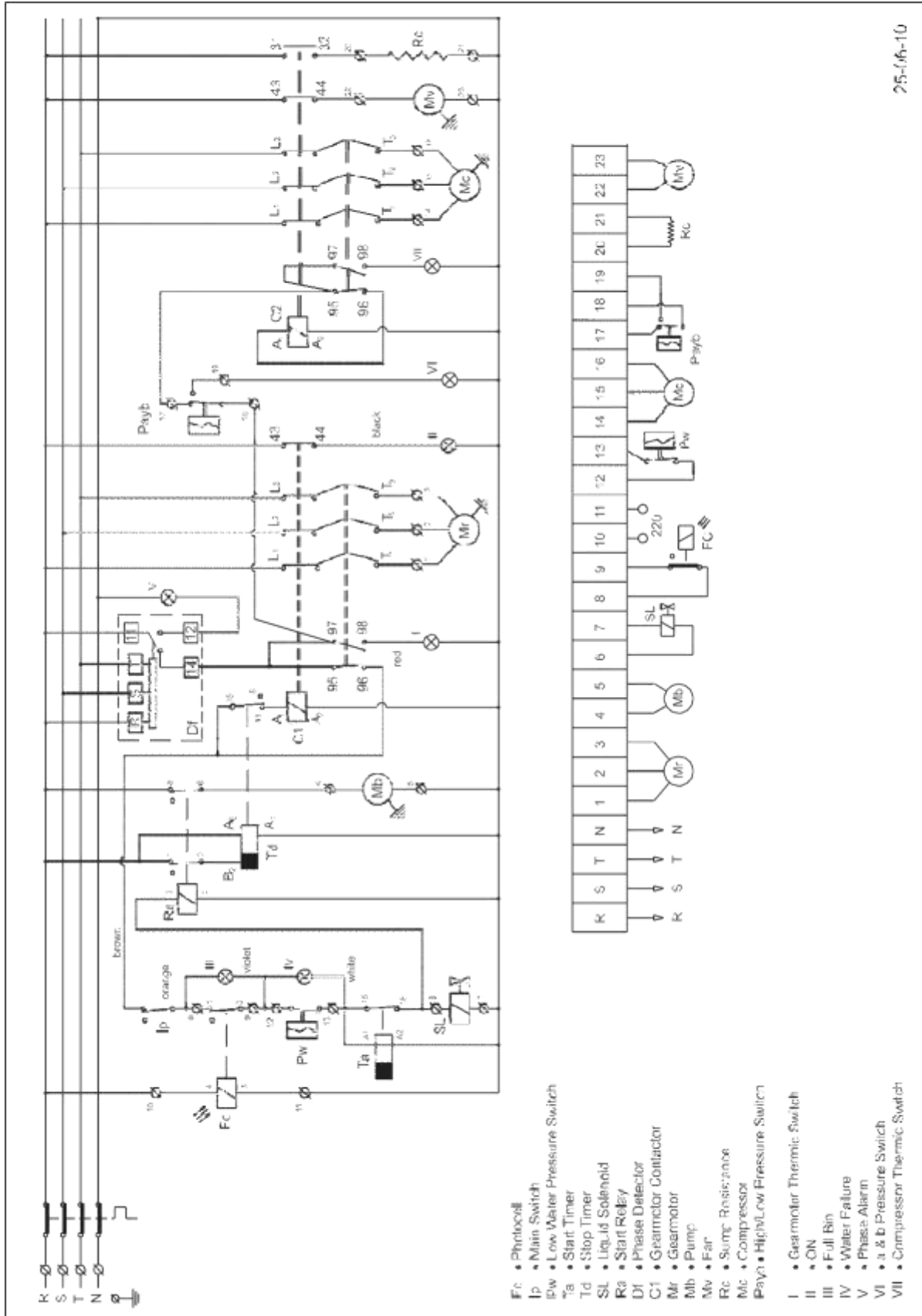

COMPACT SCL - SC with V/f driver

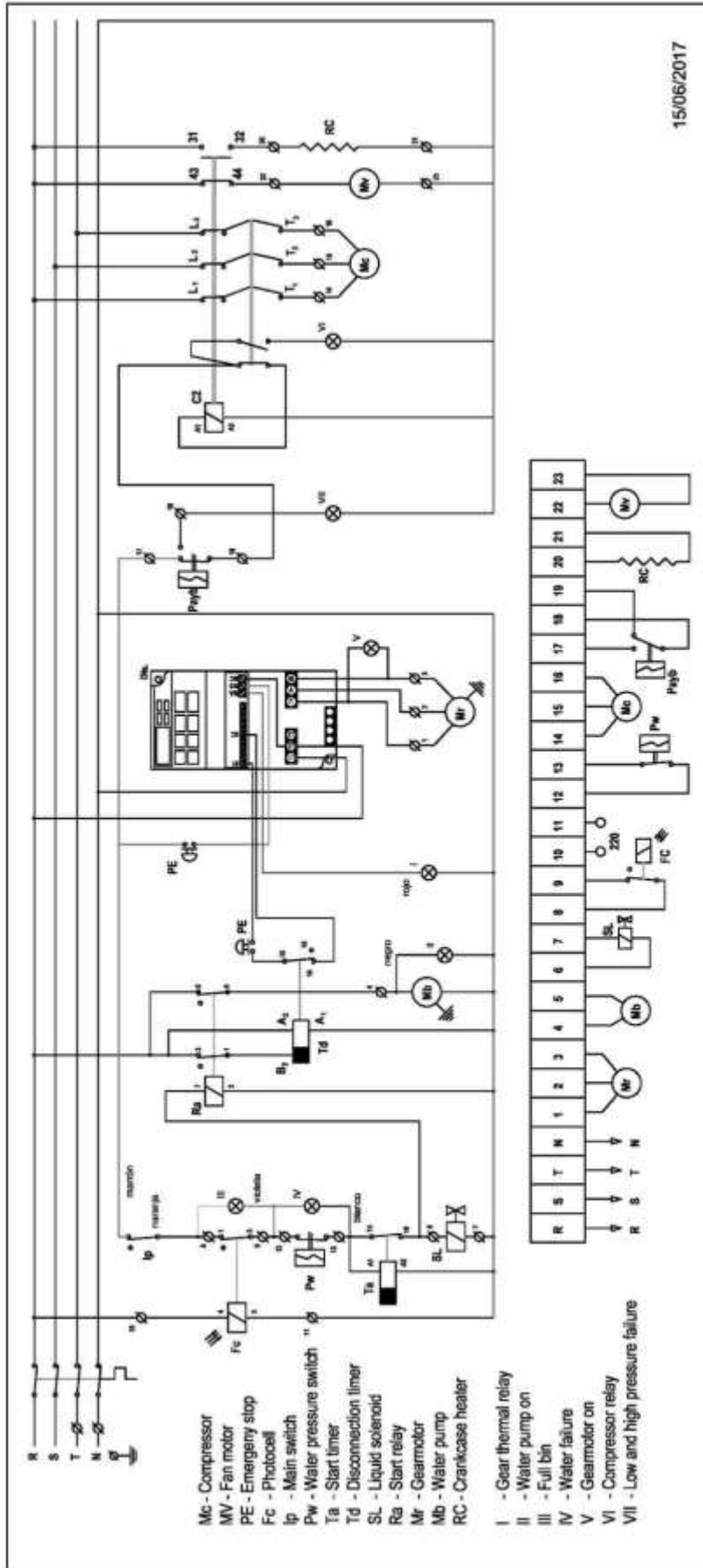

SCL SPLIT - SC SPLIT

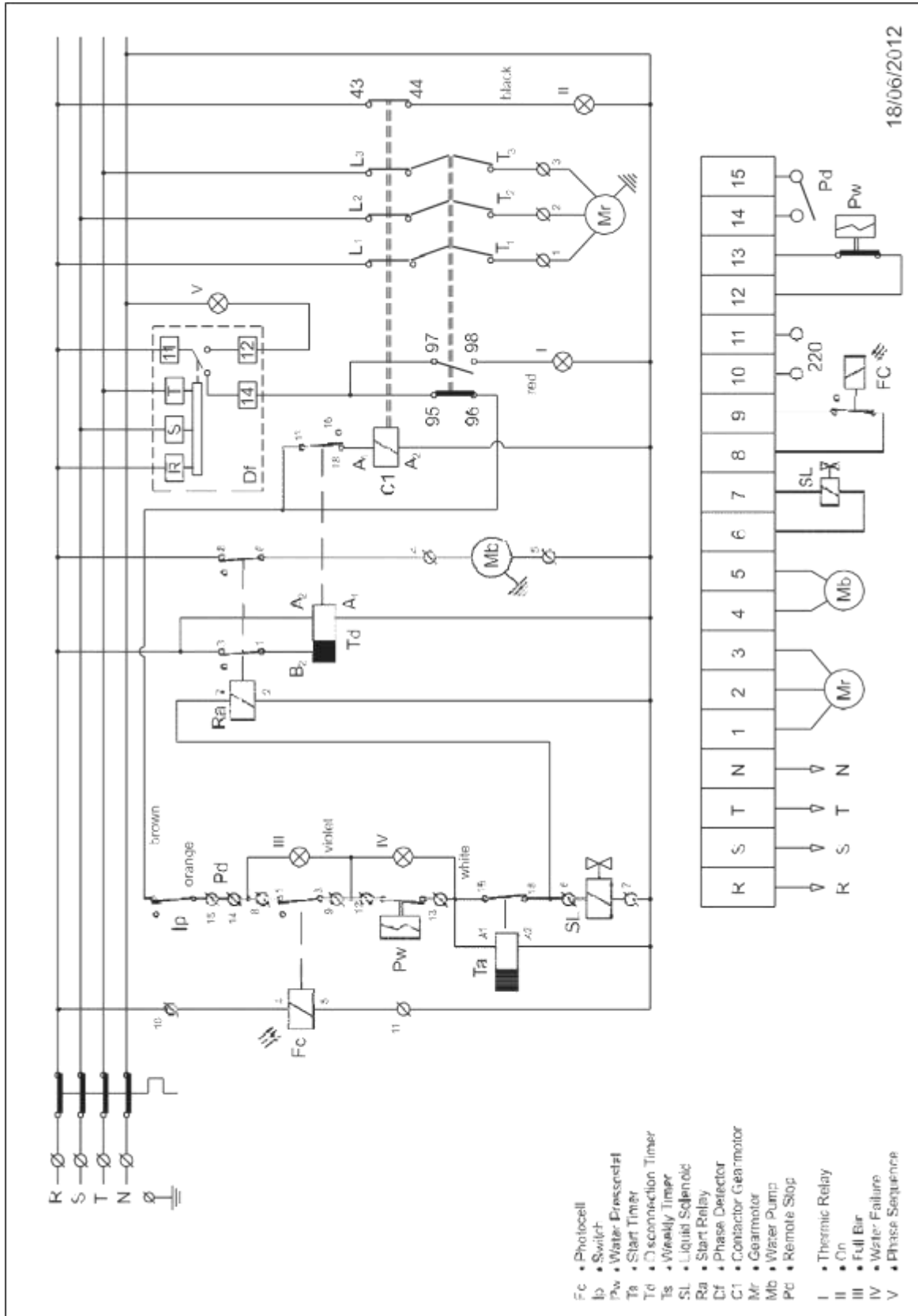

SCL SPLIT – SC SPLIT with V/f driver

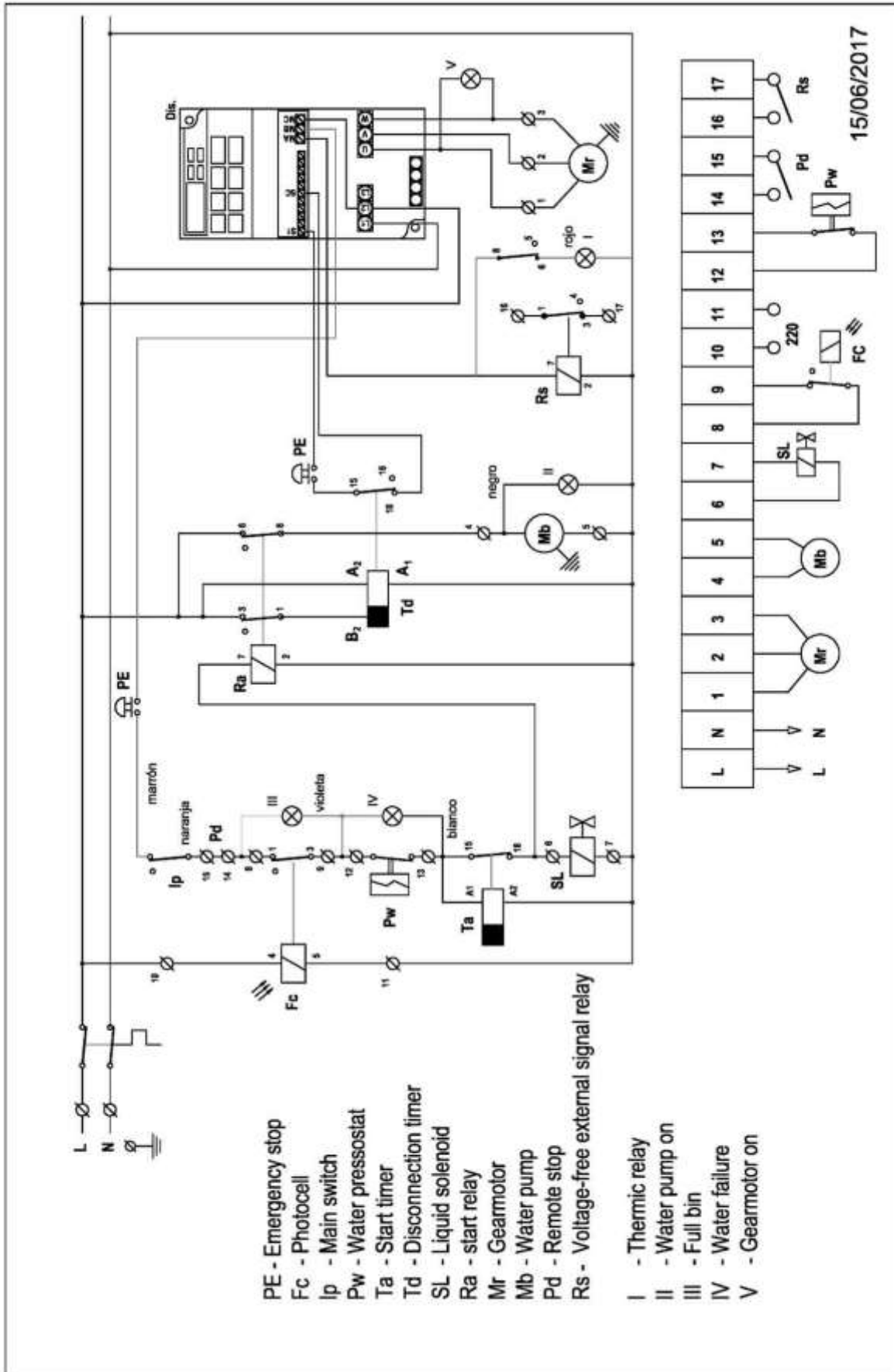

SPECIFICATIONS

SCL 400 - SC4 00 / SCL 600 - SC 600

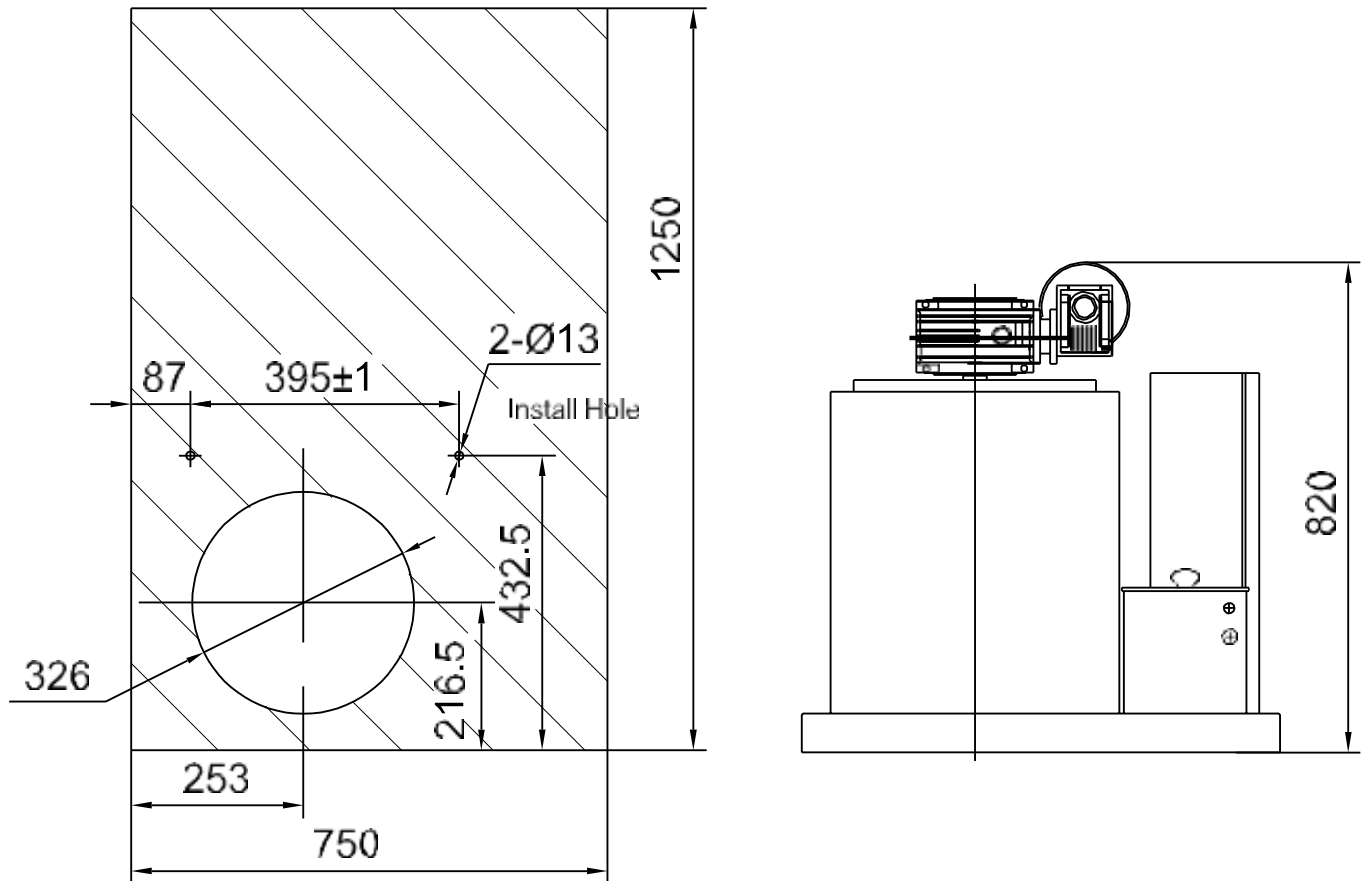

MODEL	400	600
PRODUCTION	0,4T	0,6T
REFRIGERANT	R449A	
POWER	1425W	2350W
AMBIENT TEMPERATURE	25°C	
WATER TEMPERATURE	16°C	
WATER CONSUMPTION	17 L/H	25 L/H
WATER INLET	3/4 GAS	
DRAIN	21mm	
ELECTRICAL REQUIREMENTS	380/50Hz/3N	
DIMENSIONS	1090x700x720	1250x750x820
WEIGHT	180	290
DIMENSION OF ICE OUTLET	326mm	

SCL 1T - SC 1TN / SCL 2T - SC 2TN / SCL 3T - SC 3TN

Pipe connection diagram and installation measurement and size of ice outlet of 1-3-ton ice-maker.

PIPE CONNECTION

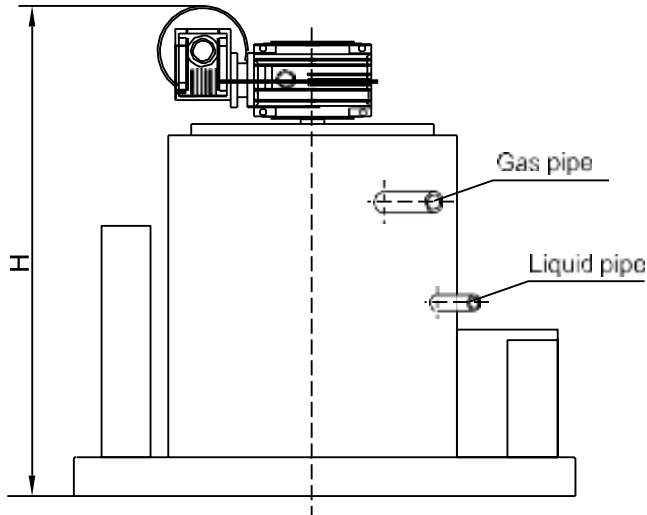

PIPE CONNECTION

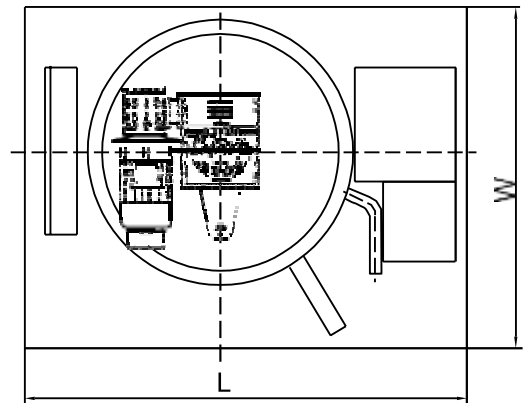

DIMENSIONS OF ICE OUTLE

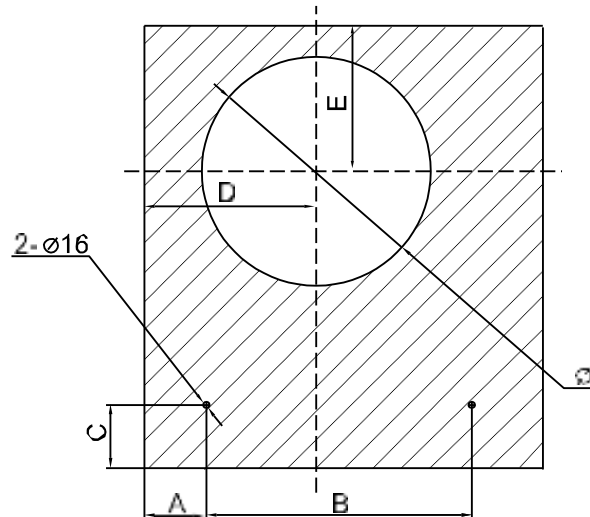

MODEL	A	B	C	D	E	L	W	H	Ø
SCL 1T - SC 1TN	150	750	198	490	310	1050	850	870	480
SCL 2T - SC 2TN	150	750	198	490	310	1050	850	1080	480
SCL 3T - SC 3TN	150	750	198	490	310	1050	850	1300	480

Pipe connection diagram and installation measurement and size of ice outlet of 5-ton and above ice-maker.

PIPE CONNECTION

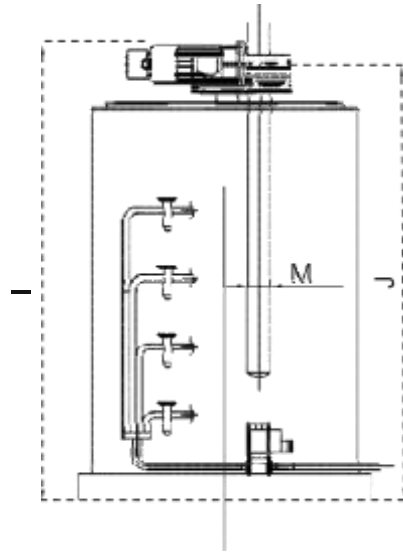

PIPE CONNECTION

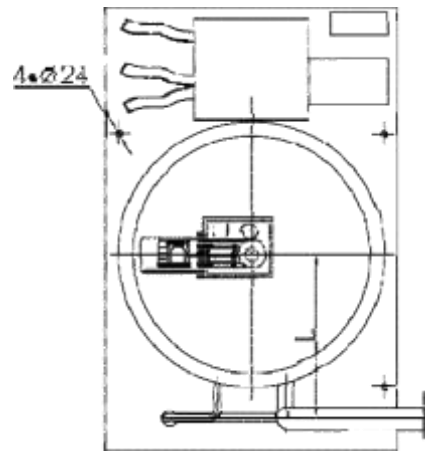

DIMENSIONS OF ICE OUTLET

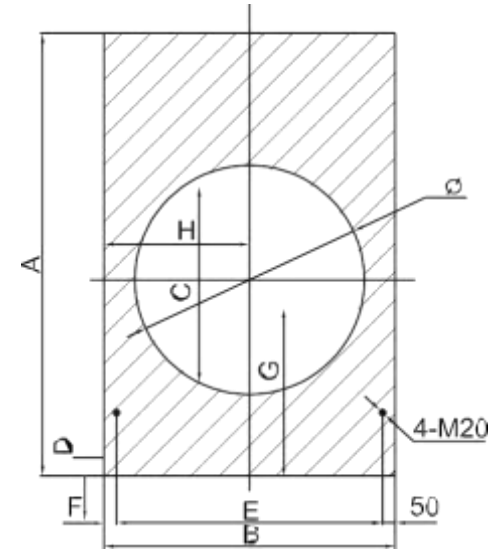

MODEL	A	B	C	D	E	F	G	H	I	J	L	M	Ø
SCL 5T - SC 5TN	1850	1150	1000±1	250	1050±1	50	775	575	1100	950	650	150	900
SCL 10T - SC10TN	1850	1150	1000±1	250	1050±1	50	775	575	1600	1500	650	150	900
SCL 15T - SC 15TN	2510	1800	1230±1	285	1700±1	50	900	900	2200	1950	960	250	1580
SCL 20T - SC 20TN	2510	1800	1230±1	285	1700±1	50	900	900	2400	2250	960	250	1580
SCL 25T - SC 25TN	2510	1800	1230±1	285	1700±1	50	900	900	2600	2450	960	250	1580
SCL 30T - SC 30TN	2835	2135	1514±1	280	2035±1	50	1067.5	1067.5	2700	2550	1150	250	1915
SCL 35T - SC 35TN	2835	2135	1514±1	280	2035±1	50	1067.5	1067.5	3200	3050	1150	250	1915

1. Production Tables

SCL 400 - SC 400

Ta/Tw	5	10	15	20	26	32	38
10	460	450	440	410	360	340	300
25	420	410	400	370	330	290	250
30	350	340	330	300	260	200	200
38	320	310	290	260	220	180	150

SCL 600 - SC 600

Ta/Tw	5	10	15	20	26	32	38
10	680	670	640	610	560	550	500
25	640	610	600	580	550	530	510
30	560	540	530	500	480	460	450
38	500	490	480	460	440	430	400

SCL 1T - SC 1TN

Ta/Tw	5	10	15	20	26	32	38
10	1200	1100	1050	1000	900	830	750
25	1100	1000	950	900	850	780	690
30	900	950	850	800	680	600	580
38	880	850	780	700	620	580	500

SCL 2T - SC 2TN

Ta/Tw	5	10	15	20	26	32	38
10	2350	2300	2100	1900	1800	1700	1500
25	2200	2100	1900	1850	1700	1500	1300
30	1900	1800	1650	1500	1300	1200	1100
38	1700	1650	1600	1400	1250	1000	900

SCL 3T - SC 3TN

Ta/Tw	5	10	15	20	26	32	38
10	3400	3300	3200	3000	2700	2500	2200
25	3300	3200	3000	2800	2500	2300	2000
30	2900	2700	2500	2300	2000	1800	1700
38	2600	2500	2400	2100	1900	1700	1580

SCL 5T - SC 5TN

Ta/Tw	5	10	15	20	26	32	38
10	5600	5500	5200	5000	4600	4200	3800
25	5400	5300	5000	4600	4300	3900	3400
30	4900	4600	4300	3900	3400	3000	2900
38	4400	4300	4000	3600	3200	2900	2500

SCL 10T - SC 10TN

Ta/Tw	5	10	15	20	26	32	38
10	11500	11200	10900	10000	9000	8300	7500
25	10900	10700	10000	9200	8500	7800	6900
30	9900	9000	8500	7900	7800	6000	5500
38	8700	8500	8000	7100	6300	5900	5700

DELIVERY AND UNPACKING

Upon receipt, thoroughly inspect the packing container. If there appears to be damage to the container contact the shipper immediately. Unpack unit in the presence of delivery personnel noting any damage on the waybill.

ITV packing bears the "Green Point" on all models according to the European Directives on management of Packaging and Waste Disposal.

Be sure to include model name and serial number on all claims. Serial number is located in the following three places:

1) Packing

There is a label stuck onto the cardboard packing bearing this serial number (1).

2) Machine body

On the back of the machine (1).

3) Machine body

Located at the back of the machine, rating plate.

Verify that the installation KIT is inside the bin, and has the following pieces:

- . 3/4' water hose, two small filters and user manual.
- . Discharge hose.



(1)



WARNING: DO NOT LEAVE PACKING MATERIALS (PLASTIC BAGS, CARDBOARD BOXES, ETC.) WITHIN REACH OF CHILDREN.

INSTALLATION

1. Recommended Placement of Unit

Sockets and wiring must comply with local standards for electrical appliances and requirements set forth on the rating plate of the machine.

Air switch must be installed within an immediate touch and shall be chose in line with the current of various types of machines, and earth wires shall be installed in assigned position on the baseboard or in the electric case according to relevant standards.

Continual water supply shall be guaranteed for the machine (Pressure is at 1.5 to 6 Bar) and water supply switch shall be mounted near the ice machine. Inlet pipeline shall be of independent type and drainage outlet shall be also not far from the ice machine. Two separate water drainage pipelines shall be required for draining the ice machine and the ice storage bin.

The ice machine shall not be placed in an airproof environment, next to heat sources, or outdoors.

To ensure ice quality, personnel responsible for installation shall be consulted about whether or not water filter or processor shall be installed according to user's local water-quality conditions.

2. Installation procedure

The ice-maker shall be lifted using the four shackles fixed on its base plate (for small-sized machine) or on its top (for large-sized machine) and shall be laid down slowly on the support or ice storage bin that has been put in place. For large-sized ice-maker, the correct steel cable lifting is as shown in this figure.

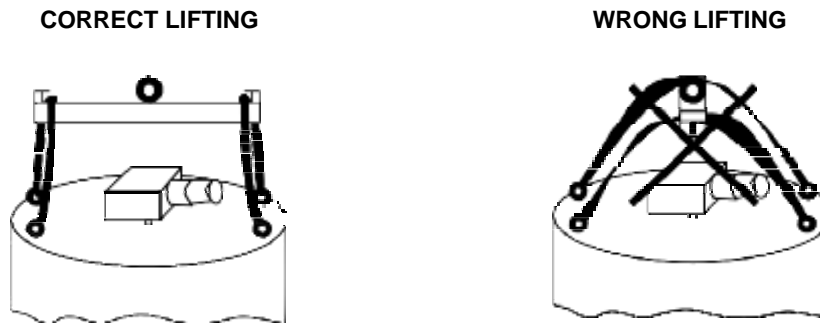

OPERATION

1. Preliminary Checks

- a) Is machine levelled?
- b) Are voltage and frequency of mains supply the same as indicated on rating plate?
- c) Is drainage system working properly?

	Minimum value	Maximum value
Ambient temperature	5°	40°
Water temperature	5°	35°
Water pressure	1,5kg/cm2	5kg/cm2
Desviation from voltage rating	-10%	6%

NOTE: To install a pressure reducer If water inlet pressure is more than 6 Bar.

ATTENTION:

Check that voltage and mains frequency is the same as in the rating plate.

2. Starting up

Open feed water valve and fill up the water tank, and the floating valve automatically closes when water level reaches the spillover port.

During trial operation, pneumatic mains switch (K1) shall be turned to “ON”, then the power indicator on the panel of electrical box (see Figure 5). Switch on the Start/Stop button on the electrical cabinet to enable the ice-maker to enter a 3-minute-delay state (indicator of Start Delay blinks) which is followed by the automatic start of gear box and water pump by the control system, and then the machine goes into operation. Observation shall be conducted at this time to verify that (1) ice blade is rotating in correct direction or the shaft and rotation is in normal status; (2) water dispensing disc is aligned with the red mark and water-dispensing pipes have normal output. In case above-stated items are all in normal operation, the Start/Stop button shall be switched off to stop the ice machine. (3) Ice production stage: Start refrigeration system and open return air valve and Freon feed valve.

3. Stop

When the "Start/Stop" button is switched off, water pump and solenoid valve stop working immediately, and the gear box stops working too after a 3-minute delay so as to remove the ice left on the interior of the vaporization cylinder. Now the pneumatic switch shall not be turned off before being delayed for 3 minutes.

Stoppage due to alarm

Stoppage due to ice full level alarm (normal stop):

When microprocessor of computer's main board detects full level of ice storage tank, the programmed process of ice full level shall be implemented: water pump and solenoid valves stop first, and then gear box motor stops after 3-minute delay and ice full level indicator turns on at the same time. Now the system is in stand-by mode. After ice is discharged, the system automatically restore to normal operating status: gear box motor, water pump and solenoid valve will be started in sequence.

IMPORTANT!

ADVISE THE FINAL USER ON MAINTENANCE PROCEDURES WHICH **ARE NOT INCLUDED IN WARRANTY**, AS WELL AS THOSE BREAKDOWNS CAUSED BY NEGLECT OF PROPER MAINTENANCE PROCEDURES.

MAINTENANCE AND CLEANING INSTRUCTIONS

IMPORTANT!

**Maintenance and cleaning procedures as well as problems derived from failing to carry them out are not covered by the warranty.

Proper maintenance is essential to obtain favourable ice quality and optimum functioning of unit.

Frequency depends on water quality and characteristics of room where unit is installed.

** Maintenance/cleaning procedures should take place at least once every six months. If concentration of air pollutants is high, complete procedures on a monthly basis.

1. Switch off the machine, turn off the water.
2. Remove the evaporator cover to clean all metal components of the evaporator: water distributor, main shaft, cutter, cutter supports, lower cross, etc...as described in point 3.
3. Cleaning of all metal parts. Dirt and surface rust stains must be completely removed by rubbing with a non-abrasive cloth or similar, which does not scratch or damage the metal surfaces of the walls and supports using soapy water, phosphoric acid in a proportion between 20 and 50% or a specific product for steel.

Dirt and surface rust must be removed with sufficient frequency when they appear, preventing them from remaining on the metal components for long periods of time.

In the case of saline environments, the frequency of cleaning should be increased, and maintenance should be carried out as soon as surface stains are observed and removed as soon as possible.

IMPORTANT: In cases of prolonged lack of cleaning, dirt and surface rust in humid conditions could attack and damage the steel of the machine components, so it is recommended to remove them as soon as they appear. Both the cleaning and the possible deterioration of the machine due to lack of cleaning are not included in the machine manufacturer's guarantee.

4. Cleaning the water collection channel. Check the condition of the water channel, clean the water collection channel and the return inlet to the bucket. Carry out the same procedure as in point 3, using a plastic bristle brush in the event of stains, accumulation of dirt or surface rust, applying soapy water.
5. Rinse the unit with water. Open the drain valve to completely empty the basin (on models that have one, if not, remove the water by external means). If there are sediments, remove them with a cloth. Close it again.
6. Switch on the machine. Start making ice and remove the ice produced in the first 5 minutes.

TROUBLESHOOTING

Fault Description	Possible Causes	Recommendations
Machine inactive (1) Power indicator not on (2) Ice full level indicator on (3) low water level indicator on	Main switch is set to OFF position	Knob selector need to be set to ON position
	Connection wire get loosened	Check the wiring
	Malfunction of ice level control assembly	Clean or replace ice level control assembly
	Blocked filters	Please refer to recommendations for low water level alarm
	Low water pressure	Clean or replace filters
Ice production decreases	Regulation valve partially blocked or improperly adjusted	Adjust or replace float valve
	Low water level of water bin	Adjust float valve to set water level
	Insufficient feed of refrigerant	Identify gas leakage and make a refrigerant load
Ice machine in operation but no ice produced	No water in water cylinder for ice production	Check water pump operation or replace it
	Gear box motor gets stuck	Check or replace it
Noise of gear box is too high	Gear box damaged or leaks lubrication oil	Check or replace it
	Gear box's bearing and teeth get worn out	

D In Übereinstimmung mit den Anforderungen der Europäischen Richtlinie 2002/96/EG über Elektro- und Elektronik-Altgeräte (WEEE) ist vorliegendes Gerät mit einer Markierung versehen. Sie leisten einen positiven Beitrag für den Schutz der Umwelt und die Gesundheit des Menschen, wenn Sie dieses Gerät einer gesonderten Abfallsammlung zuführen. Im unsortierten Siedlungsmüll könnte ein solches Gerät durch unsachgemäße Entsorgung negative Konsequenzen nach sich ziehen. Auf dem Produkt oder der beiliegenden Produktdokumentation ist

folgendes Symbol  einer durchgestrichenen Abfalltonne abgebildet. Es weist darauf hin, dass eine Entsorgung im normalen Haushaltsabfall nicht zulässig ist. Entsorgen Sie dieses Produkt im Recyclinghof mit einer getrennten Sammlung für Elektro- und Elektronikgeräte. Die Entsorgung muss gemäß den örtlichen Bestimmungen zur Abfallbeseitigung erfolgen. Bitte wenden Sie sich an die zuständigen Behörden Ihrer Gemeindeverwaltung, an den lokalen Recyclinghof für Haushaltsmüll oder an den Händler, bei dem Sie dieses Gerät erworben haben, um weitere Informationen über Behandlung, Verwertung und Wiederverwendung dieses Produkts zu erhalten.

GB This appliance is marked according to the European directive 2002/96/EC on Waste Electrical and Electronic Equipment (WEEE). By ensuring this product is disposed of correctly, you will help prevent potential negative consequences for the environment and human health, which could otherwise be caused by inappropriate waste handling of this product.

The symbol  on the product, or on the documents accompanying the product, indicates that this appliance may not be treated as household waste. Instead it shall be handed over to the applicable collection point for the recycling of electrical and electronic equipment. Disposal must be carried out in accordance with local environmental regulations for waste disposal. For more detailed information about treatment, recovery and recycling of this product, please contact your local city office, your household waste disposal service or the shop where you purchased the product.

F Cet appareil porte le symbole du recyclage conformément à la Directive Européenne 2002/96/CE concernant les Déchets d'Équipements Électriques et Électroniques (DEEE ou WEEE). En procédant correctement à la mise au rebut de cet appareil, vous contribuerez à empêcher toute conséquence nuisible pour l'environnement et la santé de l'homme.

Le symbole  présent sur l'appareil ou sur la documentation qui l'accompagne indique que ce produit ne peut en aucun cas être traité comme déchet ménager. Il doit par conséquent être remis à un centre de collecte des déchets chargé du recyclage des équipements électriques et électroniques. Pour la mise au rebut, respectez les normes relatives à l'élimination des déchets en vigueur dans le pays d'installation. Pour obtenir de plus amples détails au sujet du traitement, de la récupération et du recyclage de cet appareil, veuillez vous adresser au bureau compétent de votre commune, à la société de collecte des déchets ou directement à votre revendeur.

NL Dit apparaat is voorzien van het merkteken volgens de Europese richtlijn 2002/96/EG inzake Afgedankte elektrische en elektronische apparaten (AEEA). Door ervoor te zorgen dat dit product op de juiste manier als afval wordt verwerkt, helpt u mogelijk negatieve consequenties voor het milieu en de menselijke gezondheid te voorkomen die anders zouden kunnen worden veroorzaakt door onjuiste verwerking van dit product als afval.

Het symbool  op het product of op de bijbehorende documentatie geeft aan dat dit product niet als huishoudelijk afval mag worden behandeld. In plaats daarvan moet het worden afgegeven bij een verzamelpunt voor recycling van elektrische en elektronische apparaten. Afkanking moet worden uitgevoerd in overeenstemming met de plaatselijke milieuvoorschriften voor afvalverwerking. Voor nadere informatie over de behandeling, terugwinning en recycling van dit product wordt u verzocht contact op te nemen met het stadskantoor in uw woonplaats, uw afvalophaaldienst of de winkel waar u het product heeft aangeschaft.

E Este aparato lleva el marcado CE en conformidad con la Directiva 2002/96/EC del Parlamento Europeo y del Consejo sobre residuos de aparatos eléctricos y electrónicos (RAEE). La correcta eliminación de este producto evita consecuencias negativas para el medioambiente y la salud.

El símbolo  en el producto o en los documentos que se incluyen con el producto, indica que no se puede tratar como residuo doméstico. Es necesario entregarlo en un punto de recogida para reciclar aparatos eléctricos y electrónicos. Deséchelo con arreglo a las normas medioambientales para eliminación de residuos. Para obtener información más detallada sobre el tratamiento, recuperación y reciclaje de este producto, póngase en contacto con el ayuntamiento, con el servicio de eliminación de residuos urbanos o la tienda donde adquirió el producto.

P Este aparelho está classificado de acordo com a Directiva Europeia 2002/96/EC sobre Resíduos de equipamento eléctrico e electrónico (REEE). Ao garantir a eliminação adequada deste produto, estará a ajudar a evitar potenciais consequências negativas para o ambiente e para a saúde pública, que poderiam derivar de um manuseamento de desperdícios inadequado deste produto.

O símbolo  no produto, ou nos documentos que acompanham o produto, indica que este aparelho não pode receber um tratamento semelhante ao de um desperdício doméstico. Pelo contrário, deverá ser depositado no respectivo centro de recolha para a reciclagem de equipamento eléctrico e electrónico. A eliminação deverá ser efectuada em conformidade com as normas ambientais locais para a eliminação de desperdícios. Para obter informações mais detalhadas sobre o tratamento, a recuperação e a reciclagem deste produto, contacte o Departamento na sua localidade, o seu serviço de eliminação de desperdícios domésticos ou a loja onde adquiriu o produto.

I Questo apparecchio è contrassegnato in conformità alla Direttiva Europea 2002/96/EC, Waste Electrical and Electronic Equipment (WEEE). Assicurandosi che questo prodotto sia smaltito in modo corretto, l'utente contribuisce a prevenire le potenziali conseguenze negative per l'ambiente e la salute.

Il simbolo  sul prodotto o sulla documentazione di accompagnamento indica che questo prodotto non deve essere trattato come rifiuto domestico ma deve essere consegnato presso l'adeguato punto di raccolta per il riciclaggio di apparecchiature elettriche ed elettroniche. Disfarsene seguendo le normative locali per lo smaltimento dei rifiuti. Per ulteriori informazioni sul trattamento, recupero e riciclaggio di questo prodotto, contattare l'adeguato ufficio locale, il servizio di raccolta dei rifiuti domestici o il negozio presso il quale il prodotto è stato acquistato.

GR Αυτή η συσκευή φέρει σημαση σύμφωνα με την Ευρωπαϊκή οδηγία 2002/96/ΕΕ σχετικά με Απορριπτόμενα Ηλεκτρικά και Ηλεκτρονικά εξαρτήματα (WEEE). Εξασφαλίζοντας ότι το προϊόν αυτό απορριπτείται σωστά, θα βοηθήσετε στην πρόληψη πιθανών αρνητικών επιπτώσεων για το περιβάλλον και την ανθρώπινη υγεία, οι οποίες θα μπορούσαν να δημιουργηθούν από τον ακατάλληλο χειρισμό αυτού του προϊόντος ως απόρριμμα.

Το σύμβολο  πάνω στο προϊόν, ή στα έγγραφα που συνοδεύουν το προϊόν, υποδεικνύει ότι αυτή η συσκευή δεν μπορεί να θεωρηθεί οικιακό απόρριμμα. Αντί γι' αυτό θα πρέπει να παραδοθεί στο κατάλληλο σημείο περισυλλογής για την ανακύκλωση των ηλεκτρικών και ηλεκτρονικών εξαρτημάτων. Διαλύστε το τηρώντας την τοπική νομοθεσία για τη διάθεση των απορριμμάτων. Για πιο λεπτομερείς πληροφορίες σχετικά με την επεξεργασία, την περισυλλογή και την ανακύκλωση αυτού του προϊόντος, παρακαλούμε επικοινωνήστε με το αρμόδιο γραφείο της τοπικής σας αυτοδιοίκησης, την τοπική σας υπηρεσία αποκομιδής οικιακών απορριμμάτων ή το κατάστημα όπου αγοράσατε αυτό το προϊόν.

S Denna produkt är märkt enligt EG-direktiv 2002/96/EEC beträffande elektriskt och elektroniskt avfall (Waste Electrical and Electronic Equipment, WEEE). Genom att säkerställa en korrekt kassering av denna produkt bidrar du till att förhindra potentiella, negativa konsekvenser för vår miljö och vår hälsa, som annars kan bli följden om produkten inte hanteras på rätt sätt.

Symbolen  på produkten, eller i medföljande dokumentation, indikerar att denna produkt inte får behandlas som vanligt hushållsavfall. Den skall i stället lämnas in på en lämplig uppsamlingsplats för återvinning av elektrisk och elektronisk utrustning. Produkten måste kasseras enligt lokala miljöbestämmelser för avfallshantering. För mer information om hantering, återvinning och återanvändning av denna produkt, var god kontakta de lokala myndigheterna, ortens sophanteringstjänst eller butiken där produkten inhandlades.

N Dette apparatet er mærket i samsvare med EU-direktiv 2002/96/EC om afhending af elektrisk og elektronisk udstyr (Waste Electrical and Electronic Equipment - WEEE). Forsikre dig om at dette produktet blir afhendat på korrekt vis, slik at det ikke kan utgjøre noen helse- eller miljørisiko.

Symbolet  på produktet eller på dokumentene som følger med det, viser at dette produktet ikke må behandles som husholdningsavfall. Lever det til et autorisert mottak for resirkulering av elektrisk og elektronisk utstyr. Avhending må skje iht. de lokale renovasjonsforskriftene. For nærmere informasjon om håndtering, kassering og resirkulering av dette produktet, kontakt kommunen, renovasjonsvesenet eller forretningen der du anskaffet det.

DK Dette produkt er mærket i henhold til EU-direktiv 2002/96/EF om Kasseret elektrisk og elektronisk udstyr (WEEE). Ved at sikre, at dette produkt bliver skrottet korrekt, hjælper man med til at forhindre potentielle, negative konsekvenser for miljøet og folkesundheden, der kunne opstå gennem u hensigtsmæssig bortskaffelse af dette produkt.

Symbolet  på produktet eller på dokumenterne, der ledsager produktet, angiver, at produktet ikke må bortskaffes sammen med husholdningsaffaldet. Det skal i stedet afleveres på en genbrugsstation for elektrisk og elektronisk udstyr. Det skal skrotes i henhold til gældende lokale miljøregler for bortskaffelse af affald. For yderligere oplysninger om håndtering, genvinding og genbrug af dette produkt bedes man kontakte de lokale myndigheder, renovationsselskabet eller forretningen, hvor produktet er købt.

FIN Tämä laite on merkitty WEEE-direktiivin (Waste Electrical and Electronic Equipment) 2002/96/EC mukaisesti. Varmistamalla, että tuote poistetaan käytöstä asianmukaisesti, voidaan auttaa estämään sellaiset ympäristö- ja terveyshaitat, jotka saattaisivat aiheutua jätteiden asiattomasta käsittelystä.

Symbooli  tuoteessa tai sen dokumentaatioissa tarkoittaa, ettei laitetta saa hävittää kotitalousjätteiden mukana. Sen sijaan tuote on toimitettava sähkö- ja elektroniikkakomponenttien keräys- ja kierrätyspisteeseen. Laitteen käytöstäpoiston suhteen on noudatettava paikallisia jätehuoltomääräyksiä. Lisätietoja tuotteen käsittelystä, talteenotosta ja kierrätyksestä saa kaupungin- tai kunnanvirastosta, paikallisesta jätehuoltoilikeestä tai liikkeestä, josta tuote ostettiin.

PL Niniejsze urządzenie posiada oznaczenia zgodnie z Dyrektywą Europejską 2002/96/EC w sprawie zużytego sprzętu elektrycznego i elektronicznego (WEEE). Zapewniając prawidłowe złomowanie niniejszego urządzenia przyczynią się Państwo do ograniczenia ryzyka wystąpienia negatywnego wpływu produktu na środowisko i zdrowie ludzi, które mogłoby zaistnieć w przypadku niewłaściwej utylizacji urządzenia.

Symbool  umieszczony na produkcie lub na dołączonych do niego dokumentach oznacza, że niniejszy produkt nie jest klasyfikowany jako odpad z gospodarstwa domowego. Urządzenie, w celu jego złomowania, należy zdać w odpowiednim punkcie utylizacji odpadów w celu recyklingu komponentów elektrycznych i elektronicznych. Urządzenie należy złomować zgodnie z lokalnymi przepisami dot. utylizacji odpadów. Dodatkowe informacje na temat utylizacji, złomowania i recyklingu opisywanego urządzenia można uzyskać w lokalnym urzędzie miasta, w większym przedsiębiorstwie utylizacji odpadów lub w sklepie, w którym produkt został zakupiony.

CZ Tento spotřebič je označen v souladu s evropskou směrnicí 2002/96/ES o likvidaci elektrického a elektronického zařízení (WEEE). Zajištěním správné likvidace tohoto výrobku pomůžete zabránit případným negativním důsledkům na životní prostředí a lidské zdraví, ke kterým by nevhodnou likvidací tohoto výrobku mohlo dojít.

Symbool  na výrobku nebo na dokumentech přiložených k výrobku udává, že tento spotřebič nepatří do domácího odpadu. Spotřebič je nutné odvézt do sběrného místa pro recyklaci elektrického a elektronického zařízení. Likvidace musí být provedena v souladu s místními předpisy o ochraně životního prostředí, které se týkají likvidace odpadu. Podrobnější informace o zpracování, reuperci a recyklaci tohoto výrobku zjistíte u příslušného místního úřadu, služby pro likvidaci domovního odpadu nebo v obchodě, kde jste výrobek zakoupili.

SK Tento spotřebič je označen v súlade s Európskou smernicou 2002/96/ES o likvidácii elektrických a elektronických zariadení (WEEE). Zabezpečením, že tento výrobok bude likvidovaný správnym spôsobom, pomôžete predchádzať potenciálnym negatívnym dopadom na životné prostredie a ľudské zdravie, ktoré by sa v inom prípade mohli vyskytnúť pri nevhodnom zaobchádzaní pri likvidácii tohto výrobku.

Symbool  na výrobku alebo na sprievodných dokumentoch znamená, že s týmto výrobkom sa nesmie zaobchádzať ako s domovým odpadom. Naopak, treba ho odovzdať v zberom stredisku na recykláciu elektrických alebo elektronických zariadení. Likvidácia musí byť vykonaná v súlade s predpismi na ochranu životného prostredia pre likvidáciu odpadov. Podrobnejšie informácie o zaobchádzaní, regenerácii a recyklácii tohto výrobku si vyžiadajte na Vašom miestnom úrade, v zberných surovinách alebo v obchode, kde ste výrobok kúpili.

H A készülékem található jelzés megfelel az elektromos és elektronikus berendezések hulladékairól szóló 2002/96/EK európai irányelvben (WEEE) foglalt előírásoknak. A hulladékká vált termék szabályos elhelyezésével Ön segít elkerülni a környezettel és az emberi egészséggel kapcsolatos azon esetleges negatív következményeket, amelyeket a termék nem megfelelő hulladékkezelése egyébként okozhatna. A terméken vagy a termékhez mellékelte dokumentumokon feltüntetett

 jelzés arra utal, hogy ez a termék nem kezelhető háztartási hulladékként. Ehelyett a termék a villamos és elektronikus berendezések újrahasznosítását végző telephelyek valamelyikén kell lennie. Kiselejtezőskor a hulladékelévtőlítésra vonatkozó helyi környezetvédelmi előírások szerint kell eljárni. A termék kezelésével, hasznosításával és újrahasznosításával kapcsolatos bővebb tájékoztatásért forduljon a lakóhelye szerinti polgármesteri hivatalhoz, a háztartási hulladékok kezelését végző társasághoz vagy ahhoz a bolthoz, ahol a terméket vásárolta.

RUS Данное изделие промаркировано в соответствии с Европейской директивой 2002/96/EC по утилизации электрического и электронного оборудования (WEEE). Обеспечив правильную утилизацию данного изделия, Вы поможете предотвратить потенциальные негативные последствия для окружающей среды и здоровья человека, которые могли бы иметь место в противном случае.

Символ  на самом изделии или сопроводительной документации указывает, что при утилизации данного изделия с ним нельзя обращаться как с бытовыми отходами. Вместо этого, его следует сдавать в соответствующий пункт приема электрического и электронного оборудования для последующей утилизации. Сдача на слом должна производиться в соответствии с местными правилами по утилизации отходов. За более подробной информацией о правилах обращения с такими изделиями, их утилизации и переработки обращайтесь в местные органы власти, в службу по утилизации отходов или в магазин, в котором Вы приобрели данное изделие.

BG Този уред е маркиран в съответствие с Европейска директива 2002/96/EC "Електрическо и електронно оборудване за отпадъци" (WEEE). Като се погрижите това изделие да бъде изхвърлено по правилен начин, вие ще помогнете за предотвратяване на възможните негативни последици за околната среда и здравето на хората, които в противен случай може да бъде предизвикано от неправилно изхвърляне на това изделие.

Символът  върху изделието или върху документите, приложени към изделието, показва, че това изделие не бива да се третира като битови отпадъци. Вместо това, то трябва да се предава в специализиран пункт за рециклиране на електрическо и електронно оборудване. При изхвърлянето му спазвайте местните норми за изхвърляне на отпадъци. За по-подробна информация за третирането, възстановяването и рециклирането на това изделие се обърнете към вашата местна градска управа, към вашата служба за изхвърляне на битови отпадъци или към магазина, откъдето сте закупили изделието.

RO Acest aparat este marcat în conformitate cu Directiva Europeană 2002/96/CE referitoare la Deșeurile de Echipament Electric și Electronic (WEEE). Asigurându-vă că acest produs este eliminat în mod corect, contribuiți la prevenirea potențialelor consecințe negative asupra mediului înconjurător și sănătății persoanelor, consecințe care ar putea fi provocate de aruncarea necorespunzătoare la gunoi a acestui produs.

Simbolul  de pe produs, sau de pe documentele care însoțesc produsul, indică faptul că acesta nu poate fi aruncat împreună cu deșeurile menajere. Trebuie predat la punctul de colectare corespunzător, pentru recidarea echipamentului electric și electronic. Anunțarea la gunoi a aparatului trebuie făcută în conformitate cu normele locale pentru eliminarea deșeurilor. Pentru informații mai detaliate privind eliminarea, valorificarea și recidarea acestui produs, vă rugăm să contactați administrația locală, serviciul de eliminare a deșeurilor menajere sau magazinul de unde ați cumpărat produsul.